

This drawing is property of Spring City Elect. Mfg. and is issued to the recipient with the understanding that it shall not be copied, duplicated, passed on to unauthorized parties, nor used for any purpose other than that for which it is specifically furnished except with Spring City's written permission.

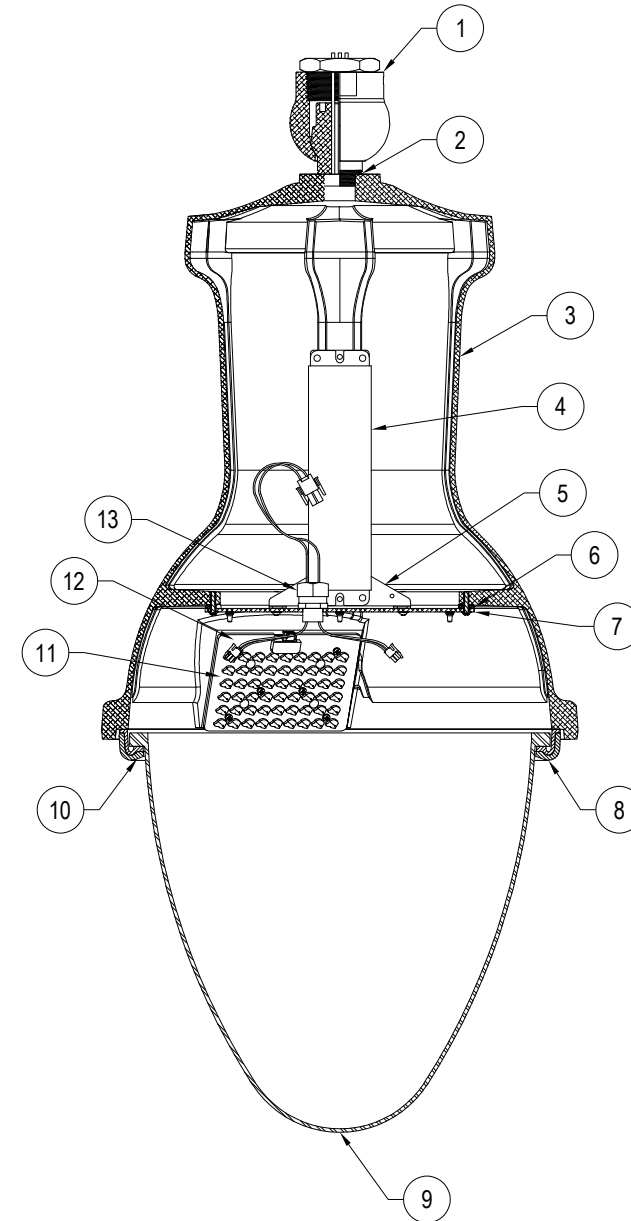
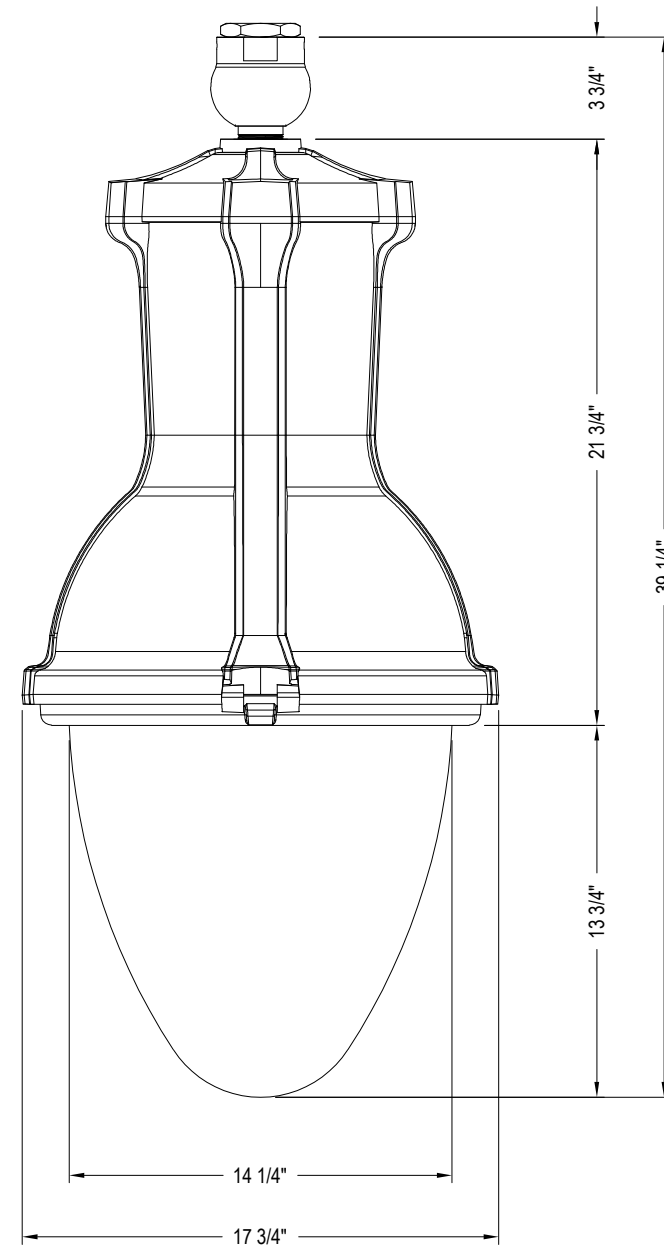

- 1) VERTICAL ALIGNMENT COUPLING: MACHINED ALUMINUM COUPLING TO ACCEPT 1 1/2" NPT CONNECTION, SECURED WITH (1) 1/4-20 SET SCREW
- 2) LUMINAIRE CONNECTION: 1 1/4" N.P.T. PIPE THREAD, FOR COUPLING ATTACHMENT, SECURED WITH (1) 1/4-20 SET SCREW
- 3) UNI-BODY LUMINAIRE CASTING: CAST ALUMINUM, 356 ALLOY WITH COOLCAST HEAT DISSIPATING PROVISIONS
- 4) LED DRIVER: DRIVER TO BE DETERMINED (BASED ON REQUIRED WATTAGE), SECURED WITH (2) 1/4-20 MACHINE SCREWS
- 5) BRACKET: 16 GAUGE, GALVANIZED STEEL DRIVER BRACKET, SECURED WITH (2) 10-24 MACHINE SCREWS
- 6) GASKET: SILICONE GASKET TO SEAL DRIVER CHAMBER FROM OPTICAL CHAMBER
- 7) BRACKET: 8 GAUGE, ALUMINUM DRIVER HOUSING PLATFORM, SECURED WITH (6) 10-24 MACHINE SCREWS
- 8) LOWER RING: CAST ALUMINUM, 356 ALLOY
- 9) GLOBE: TYPE III REFRACTIVE POLYCARBONATE
- 10) GASKET: SILICONE GASKET, TO SEAL GLOBE AND ONE-PIECE BODY TO GLOBE RING
- 11) 1 WATT LED CHIPS (SEE LUMINAIRE SPECIFICATIONS FOR REQUIRED SYSTEM WATTAGE)
- 12) CROSSFIRE GENERATION TWO OPTICAL SYSTEM: INJECTION MOLDED REFRACTIVE ACRYLIC, TYPE IV (ASYMMETRIC) DISTRIBUTION
- 13) CORD GRIP: MULTICORD LIQUID TIGHT NYLON CORD GRIP, 4 CORD, 3/8" NPT SIZE

LUMINAIRE SPECIFICATIONS

STYLE:	COLUMBIA
HEIGHT:	39 1/4"
WIDTH:	17 3/4"
MATERIAL:	CAST ALUMINUM ALLOY A.N.S.I. 356, PER A.S.T.M. B26-95
GLOBE:	TYPE III REFRACTIVE POLYCARBONATE
FINISH:	POWDER COAT - TO MATCH SHERWIN WILLIAMS ACROLON - BLACK CHERRY (SW2724)
LAMPING:	200 WATT LED SYSTEM
VOLTAGE:	ELECTRONIC WIRED AT 120-277 VOLTS
COLOR TEMPERATURE:	4000K (MEDIUM WHITE)
OPTICAL SYSTEM:	TYPE III REFRACTIVE ACRYLIC OPTICS (ASYMMETRIC) DISTRIBUTION
MODIFIERS:	- DIMMING CAPABLE DRIVER - VERTICAL ALIGNMENT COUPLING - 10KV SURGE PROTECTION
CATALOG NO.:	ALMCLU-LE200/EVX/X2-40-CR3-LAVBC-PLC3-CU



Spring City Electrical Mfg. Co.

HALL AND MAIN STREETS - P.O. BOX 19 - SPRING CITY, PA. 19475
PHONE (610) 948-4000 - FAX (610) 948-5577 - WWW.SPRINGCITY.COM

DESCRIPTION	THE UNI-BODY COLUMBIA LED LUMINAIRE		
CUSTOMER			
JOB			
SCALE	DRAWN BY:	DATE	DRAWING NO.
N.T.S.	B.K.R.	10-24-2017	FIX-30088

1) UPPER LUMINAIRE CASTING: CAST ALUMINUM, 356 ALLOY, WELDED TO ALUMINUM BODY

2) LUMINAIRE BODY: 8 GAUGE, ONE PIECE SPUN 1100-0 ALUMINUM BODY, WELDED TO UPPER CASTING AND 6063 FORMED ALUMINUM ALLOY

3) QUICK DISCONNECT: UNIVERSAL MATE-N-LOK CONNECTOR, 3 POSITION

4) DRIVER BRACKET: FORMED BRACKET TO MOUNT DRIVER AND SURGE PROTECTOR, SECURED WITH (2) 1/4-20 ROUND HEAD MACHINE SCREWS

5) STRUT FOR LUMINAIRE: CAST ALUMINUM, 356 ALLOY, WELDED TO ALUMINUM BODY

6) DRIVER: (1) 150 WATT PHILIPS ADVANCE "TITANIUM" (1050 mA) DRIVER, SECURED WITH (2) 1/4-20 ROUND HEAD MACHINE SCREWS (CATALOG NO.: X1150C105V140CNF1)

7) COOLCAST® HEAT DISSIPATING CAP: ONE PIECE CAST ALUMINUM, 356 ALLOY, SECURED TO HINGED GLOBE RING WITH (8) 10-24 ROUND HEAD MACHINE SCREWS

8) UPPER HINGED RING: CAST ALUMINUM, 356 ALLOY, WELDED TO ALUMINUM BODY, CAST WITH (21) 1/4" WIDE X 3/4" LONG OPENINGS FOR IMPROVED AIR FLOW TO COOLCAST® LED CAP

9) LOWER HINGED GLOBE RING: CAST ALUMINUM, 356 ALLOY, COMPRESSING THE GLOBE TO THE LOWER CASTING, SECURED WITH (2) 10-24 ROUND HEAD MACHINE SCREWS, HINGE MACHINED TO ACCEPT A (1) 10-24 STAINLESS STEEL SHOULDER BOLT

10) GLOBE: FORMED CLEAR STIPPLED ACRYLIC

11) GASKET: NEOPRENE GASKET TO SEAL CONNECTION BETWEEN GLOBE AND LOWER CASTING

12) HINGE PIN: (1) 10-24 X 1" SHOULDER BOLT WITH 1/4" DIA. BARREL

13) QUICK DISCONNECT: MICRO MATE-N-LOK CONNECTOR, 2 POSITION, MALE

14) 1 WATT LED CHIPS; 90 TOTAL CHIPS CONTRIBUTE TO A 155 WATT SYSTEM (45 CHIPS POPULATED PER LED BOARD)

15) MEDALLION: CAST ALUMINUM, 356 ALLOY, WELDED TO ALUMINUM BODY

16) LED OPTICAL SYSTEM: INJECTION MOLDED REFRACTIVE OPTICS WITH TYPE III DISTRIBUTION

17) LED BOARD: ALUMINUM CORE BOARD WITH THERMAL INTERFACE MATERIAL

18) CORD GRIP: MULTICORD LIQUID TIGHT NYLON CORD GRIP, 4 CORD, 3/8" NPT SIZE

19) SURGE PROTECTOR: 120-277 VAC 10KV SURGE PROTECTION, METAL OXIDE VARISTOR (MOV) CONNECTION AT THE FIRST STAGE OF INPUT POWER (CATALOG NO.: PHILIPS SP1)

20) DECORATIVE HOOP: 6063 FORMED ALUMINUM ALLOY, WELDED TO ALUMINUM BODY AND UPPER CASTING

SURGE PROTECTOR: 120-277 VAC 10KV SURGE PROTECTION, METAL OXIDE VARISTOR (MOV) CONNECTION AT THE FIRST STAGE OF INPUT POWER (CATALOG NO.: PHILIPS SP1)

21) POWER CABLE: BUNDLED WIRES SUPPLIED WITH QUICK DISCONNECTS

△ 22) LUMINAIRE CONNECTION: 2" N.P.T. PIPE THREAD, FOR COUPLING ATTACHMENT, SECURED WITH (1) 1/4-20 SET SCREW

△ 23) VERTICAL ALIGNMENT COUPLING: MACHINED ALUMINUM COUPLING TO ACCEPT 1 1/2" NPS CONNECTION, SECURED WITH (1) 1/4-20 SET SCREW

This drawing is property of Spring City Elect. Mfg. and is issued to the recipient with the understanding that it shall not be copied, duplicated, passed on to unauthorized parties, nor used for any purpose other than that for which it is specifically furnished except with Spring City's written permission.

LUMINAIRE SPECIFICATIONS

STYLE:	BENJAMIN FRANKLIN PARKWAY LED LUMINAIRE
HEIGHT:	38 3/8"
WIDTH:	23 3/4" DIAMETER
MATERIAL:	CAST ALUMINUM ALLOY A.N.S.I. 356, PER A.S.T.M. B26-95 WITH 8 GAUGE, 1100-0 SPUN ALUMINUM BODY STIPPLED ACRYLIC
GLOBE:	POWDER COATED - CITYSCAPE GREEN
△ FINISH:	155 WATT LED SYSTEM
LAMPING:	ELECTRONIC WIRED AT 120-277 VOLTS
VOLTAGE:	4000K (MEDIUM WHITE)
COLOR TEMPERATURE:	TYPE III CROSSFIRE REFRACTIVE OPTICS (ASYMMETRIC DISTRIBUTION)
OPTICAL SYSTEM:	10KV SURGE PROTECTION
SURGE:	
CATALOG NO.:	ALMBFP-LE155/EVX/X2-40-CR3-YBFP-LAVBC-CU

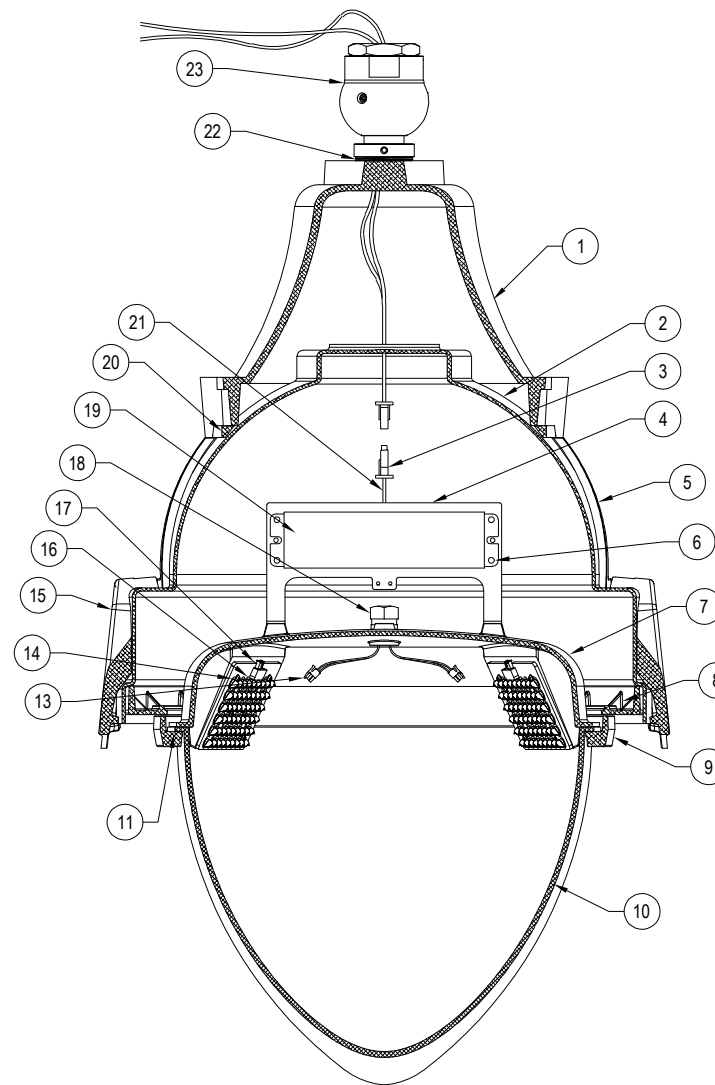
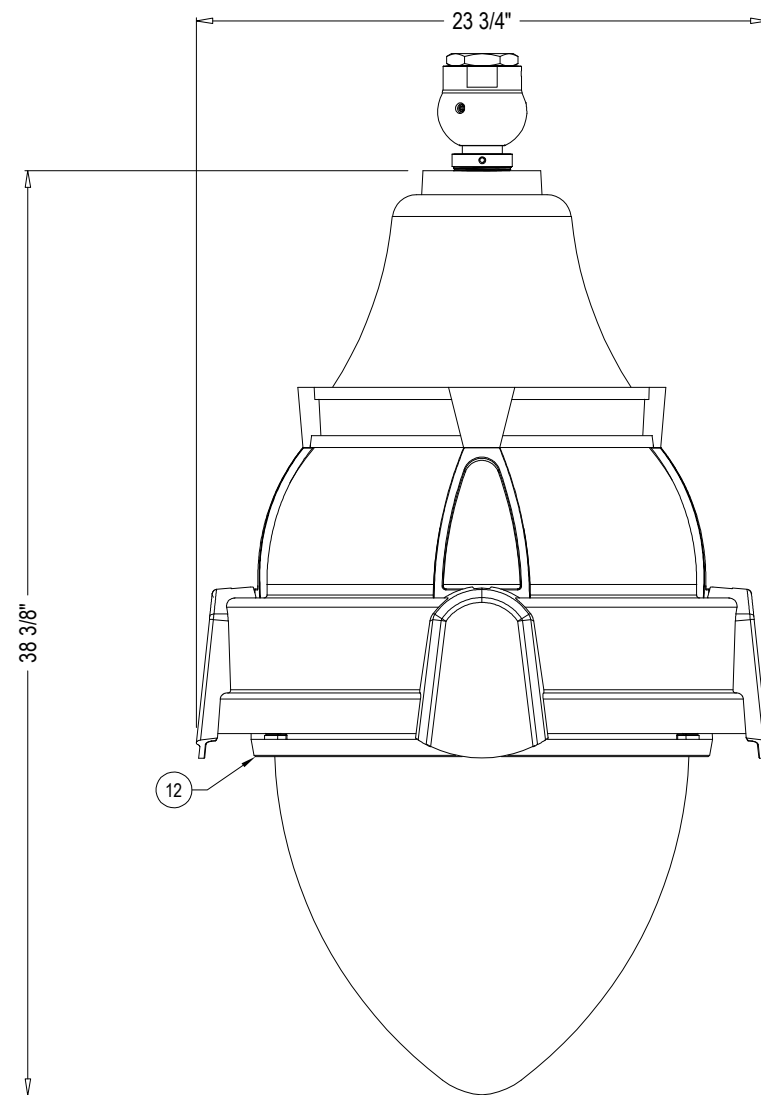

△ REVISED BY: J.H.P. DATE: 12-19-18

△ REVISED BY: T.E.B. DATE: 05-16-18



Spring City Electrical Mfg. Co.

HALL AND MAIN STREETS - P.O. BOX 19 - SPRING CITY, PA. 19475
PHONE (610) 948-4000 - FAX (610) 948-5577 - WWW.SPRINGCITY.COM

DESCRIPTION THE BENJAMIN FRANKLIN PARKWAY LED LUMINAIRE

CUSTOMER
JOB

SCALE N.T.S.	DRAWN BY: T.E.B.	DATE 09-22-2015	DRAWING NO. FIX-29378
-----------------	---------------------	--------------------	--------------------------

This drawing is property of Spring City Elect. Mfg. and is issued to the recipient with the understanding that it shall not be copied, duplicated, passed on to unauthorized parties, nor used for any purpose other than that for which it is specifically furnished except with Spring City's written permission.

- 1) TWIST LOCK PHOTO CELL: WIRED FOR 208V THROUGH 240V
- 2) 7-PIN TWIST LOCK PHOTO CELL RECEPTACLE
- 3) BUNDLED POWER CABLES FROM PHOTO CELL RECEPTACLE (WIRED INTO DRIVER FOR DIMMING CONTROLS)
- 4) COOLCAST HEAT DISSIPATING ROOF: CAST ALUMINUM, 356 ALLOY, SECURED WITH (4) 10-24 ROUND HEAD MACHINE SCREWS
- 5) GASKET: MOLDED SILICONE TO SEAL ROOF TO GLOBE
- 6) UPPER CAGE RING: CAST ALUMINUM, 356 ALLOY
- 7) QUICK DISCONNECTS FOR WIRING OF LED LIGHT ENGINES
- 8) QUICK DISCONNECT SUPPLIED FOR DISCONNECTING ROOF ASSEMBLY FROM CAGE ASSEMBLY
- 9) DRIVER HOUSING: SPUN ALUMINUM SECURED WITH (3) 10-24 ROUND HEAD PHILLIPS MACHINE SCREWS
- 10) SURGE PROTECTOR: 10KV PROTECTION
- 11) GASKET: MOLDED SILICONE TO SEAL GLOBE TO GLOBE SEAT
- 12) STOP RING: CAST INTO FITTER
- 13) LUMINAIRE FITTER: CAST ALUMINUM, 356 ALLOY
- 14) POLE WIRE HARNESS: 10 GAUGE WIRES SUPPLIED WITH QUICK DISCONNECT FOR INCOMING POWER (16'-0" MINIMUM LENGTH)
- 15) LUMINAIRE WIRE HARNESS: 14 GAUGE WIRES SUPPLIED WITH QUICK DISCONNECT FOR INCOMING POWER
- 16) LUMINAIRE GLOBE SEAT: CAST ALUMINUM, 356 ALLOY
- 17) LED DRIVER: 150W DRIVER WIRED AT 700mA (SPLIT CURRENT) WITH 0-10V DIMMING (PHILIPS #LEDINTA0700C210DO)
- 18) GLOBE: 199 STIPPLED ACRYLIC
- 19) LUMINAIRE CAGE STRUT: (4 PIECES) CAST ALUMINUM, 356 ALLOY
- 20) CROSSFIRE OPTICAL SYSTEM: INJECTION MOLDED REFRACTIVE OPTICS
- 21) CREE XT-E LED - 54 CHIPS PER BOARD TO PRODUCE A 120 WATT SYSTEM
- 22) DECORATIVE DENTAL RING: (2 PIECES) CAST ALUMINUM, 356 ALLOY

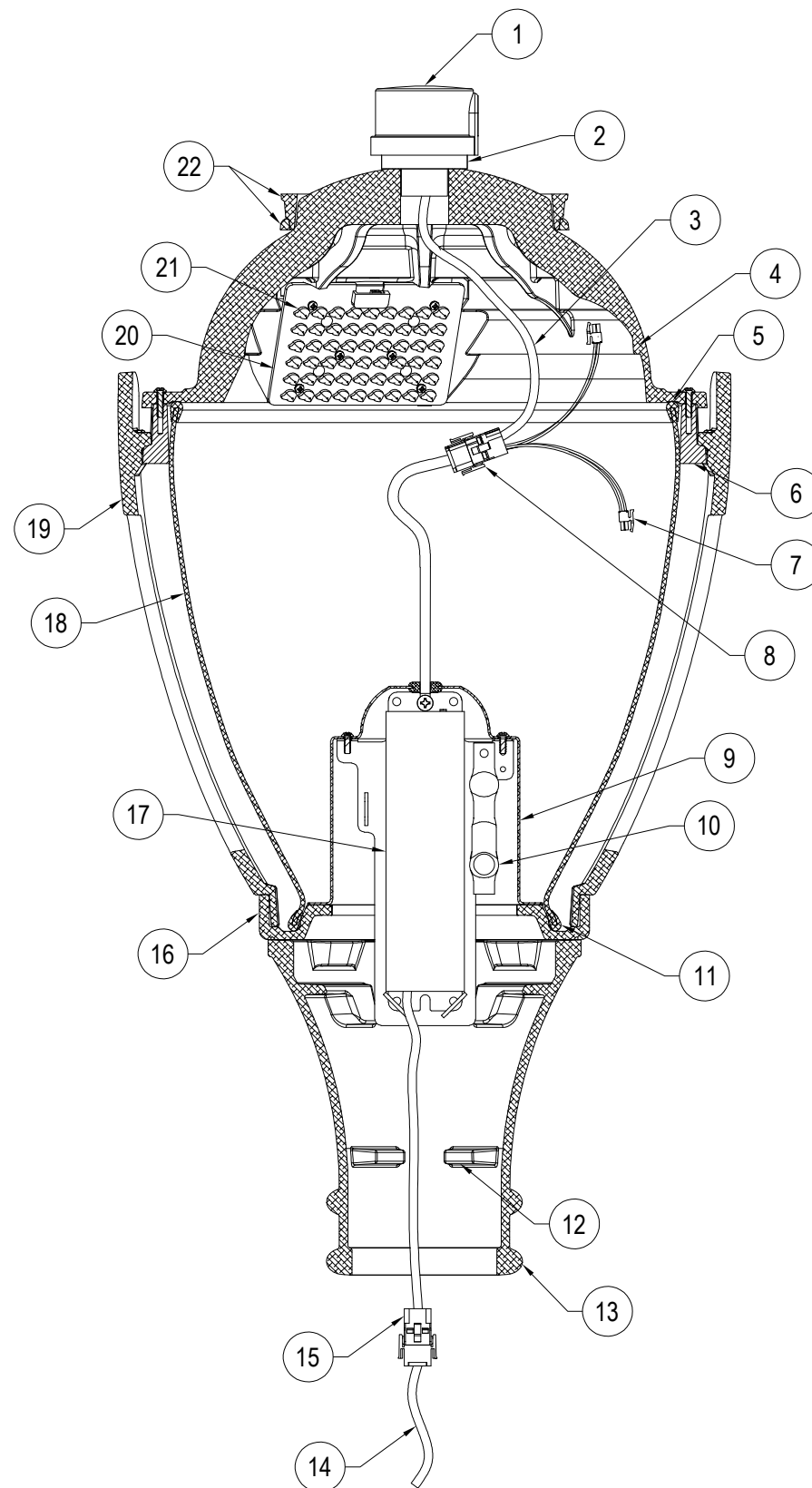
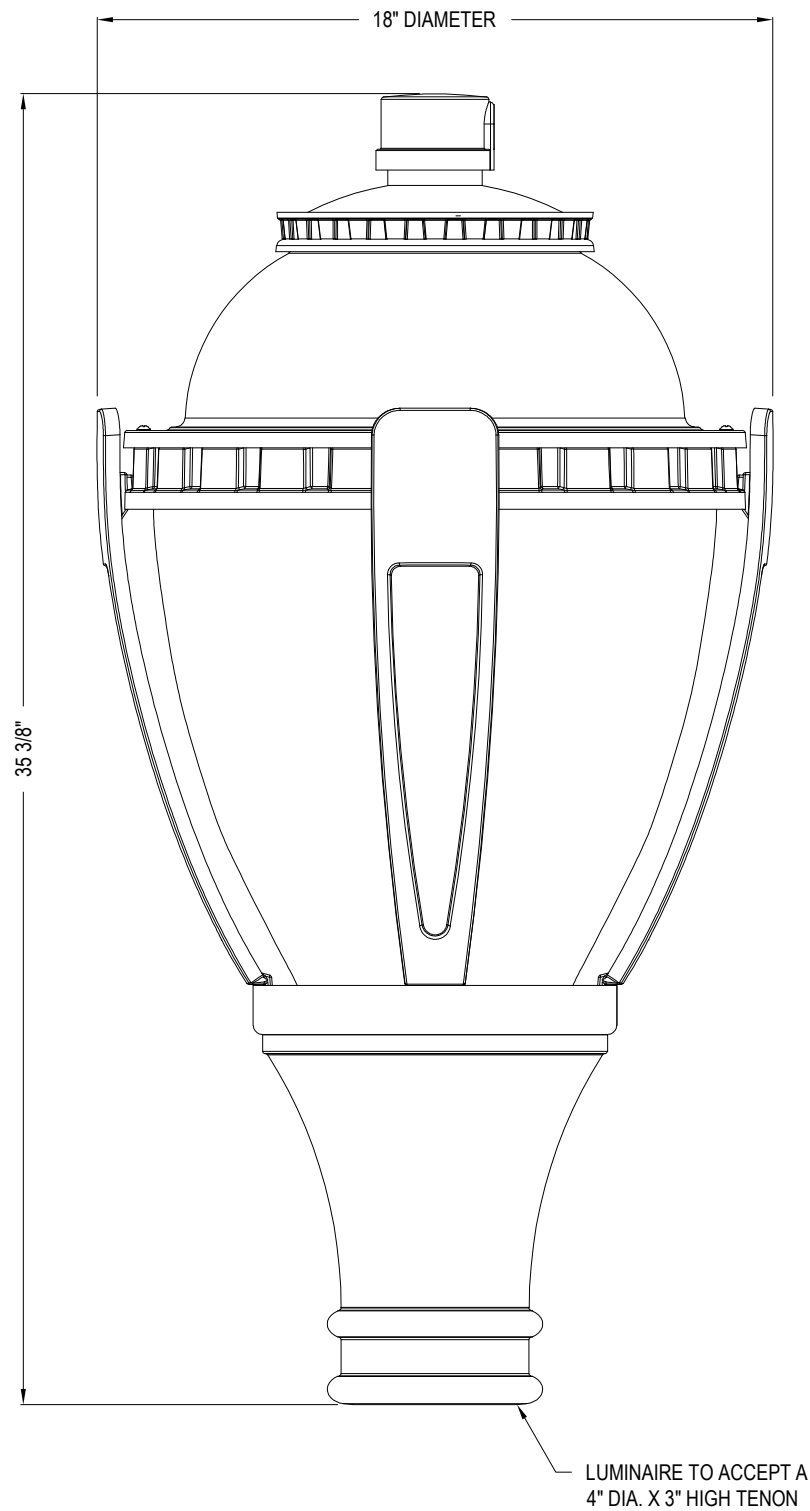

LUMINAIRE SPECIFICATIONS:

STYLE:	CENTER CITY
HEIGHT:	35 3/8"
WIDTH:	18" DIAMETER
MATERIAL:	CAST ALUMINUM ALLOY ANSI 356 PER A.S.T.M. B26-95
FINISH:	POWDER COAT - CITYSCAPE GREEN
LAMPING:	120 WATT LED SYSTEM
VOLTAGE:	ELECTRONIC WIRED AT 120-277 VOLTS
COLOR TEMP.:	4000K (MEDIUM WHITE)
OPTICS:	TYPE III CROSSFIRE REFRACTIVE OPTICS (ASYMMETRIC DISTRIBUTION)
GLOBE:	199 STIPPLED ACRYLIC
MODIFIER:	7-PIN TWIST LOCK DIMMING RECEPTACLE
DIMMING:	0-10V
SURGE PROTECTION:	10kV
CATALOG NO.:	ALMCTR-LE120/EVX/X2-40-CR3-YS19-TR7P-CU



Spring City Electrical Mfg. Co.

HALL AND MAIN STREETS - P.O. BOX 19 - SPRING CITY, PA. 19475
PHONE (610) 948-4000 - FAX (610) 948-5577 - WWW.SPRINGCITY.COM

DESCRIPTION	THE CENTER CITY LED LUMINAIRE		
CUSTOMER	JOB		
SCALE	DRAWN BY:	DATE	DRAWING NO.
N.T.S.	MWG	06-12-15	FIX-29264

This drawing is property of Spring City Elect. Mfg. and is issued to the recipient with the understanding that it shall not be copied, duplicated, passed on to unauthorized parties, nor used for any purpose other than that for which it is specifically furnished except with Spring City's written permission.

- 1) PHOTO CONTROL: 7-PIN TWIST LOCK PHOTO CONTROL RECEPTACLE SUPPLIED WITH SHORTING CAP
- 2) MOUNTING RING: ALUMINUM, 6061 ALUMINUM, WELDED TO ROOF
- 3) ROOF: CAST ALUMINUM, 356 ALLOY, SECURED WITH (4) 1/4"-20 MACHINE SCREWS
- 4) ROOF MOUNTING PLATE: CAST ALUMINUM, 356 ALLOY, WELDED TO CAGE ASSEMBLY
- 5) ROOF TRIM: 0.125" THICK FORMED ALUMINUM DECORATIVE TRIM WORK, WELDED TO CAGE ASSEMBLY
- 6) BRASS BALL: 1" DIA. POLISHED BRASS BALLS EACH SECURED WITH 1/8" IPS BRASS NIPPLE
- 7) CAGE PANEL: CAST ALUMINUM, 356 ALLOY, 4 PIECES WELDED TOGETHER TO FORM CAGE
- 8) PANEL INSERTS: LASER CUT DECORATIVE PANEL ELEMENTS, 12 GA. ALUMINUM
- 9) PANELS: SEEDED ACRYLIC PANELS
- 10) PANEL RETAINERS: FORMED ALUMINUM PANEL RETAINERS, 4 REQUIRED EACH SECURED WITH (2) 10-24 MACHINE SCREWS
- 11) UPPER FITTER: CAST ALUMINUM, 356 ALLOY, WELDED TO CAGE ASSEMBLY
- 12) LED SEAT: CAST ALUMINUM, 356 ALLOY, WELDED TO CAGE ASSEMBLY
- 13) LOWER FITTER: CAST ALUMINUM, 356 ALLOY, WELDED TO CAGE ASSEMBLY
- 14) DRIVER BRACKET: FORMED GALVANIZED STEEL BRACKET MOUNTED TO FIXTURE WITH (2) 10-24 MACHINE SCREWS
- 15) POWER CABLE: BUNDLED POWER CABLE WIRE WITH QUICK DISCONNECTS
- 16) LED DRIVER: DRIVER AND DRIVE CURRENT DETERMINED BY REQUIRED WATTAGE
- 17) X-SERIES LED MODULE: INTERNAL CAST ALUMINUM, 356 ALLOY, WITH (3) 10-24 MACHINE SCREWS
- 18) OPTICAL SYSTEM: TYPE III REFRACTIVE ACRYLIC OPTICS (ASYMMETRIC DISTRIBUTION)
- 19) LED CHIPS: SEE LUMINAIRE SPECIFICATIONS FOR REQUIRED SYSTEM WATTAGE

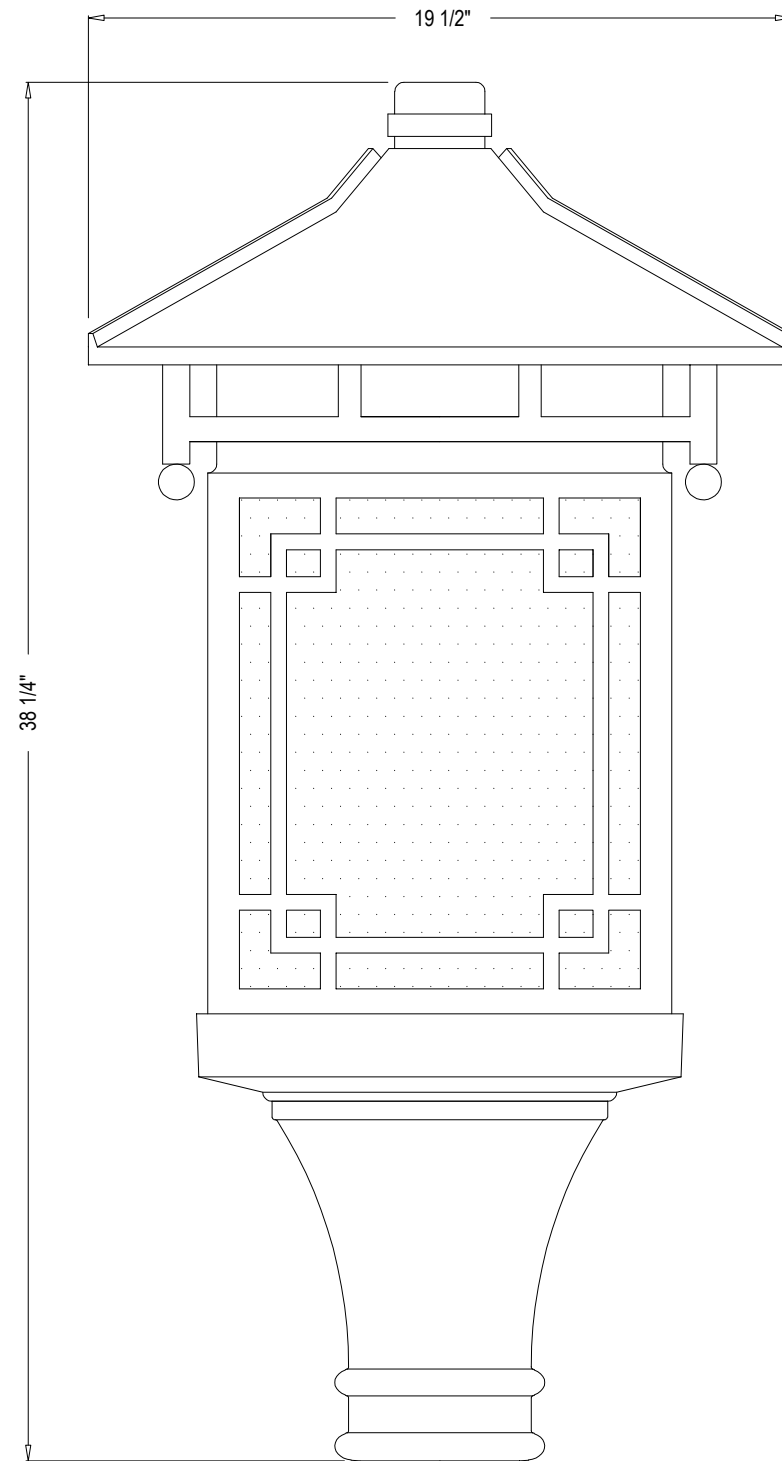

LUMINAIRE TO ACCEPT A 4" DIA. X 3" HIGH TENON

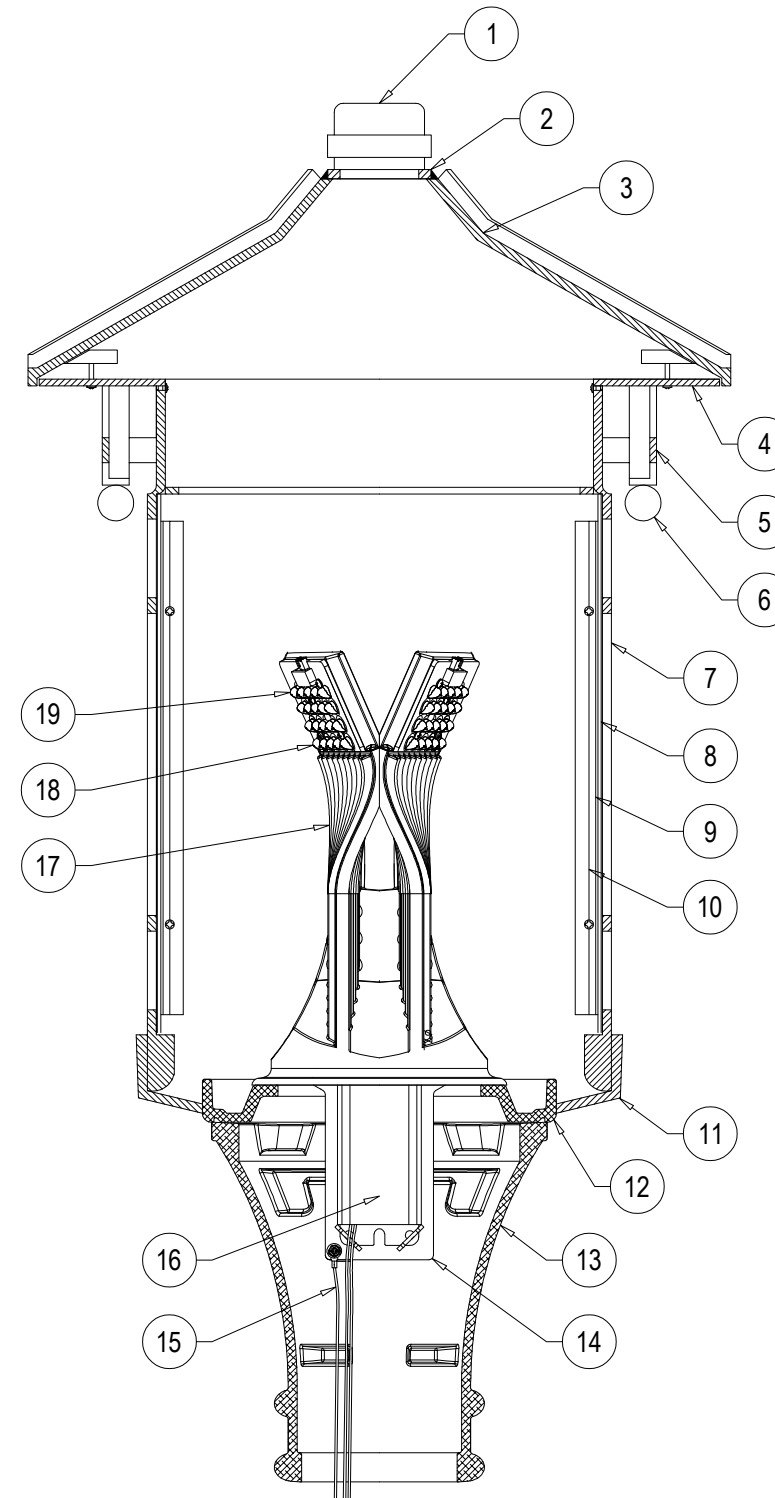

LUMINAIRE SPECIFICATIONS:

STYLE: CCD CHINATOWN
 HEIGHT: 38 1/4"
 WIDTH: 19 1/2" SQUARE
 MATERIAL: CAST ALUMINUM SAND CASTING ALLOY A.N.S.I. 356 PER A.S.T.M. B26-95 AND SPUN ALUMINUM
 PANELS: SEEDED ACRYLIC
 FINISH: POWDER COAT - RAL 3011 (CHINATOWN RED)
 LAMPING: 100 WATT LED SYSTEM
 VOLTAGE: ELECTRONICALLY WIRED AT 120-277 VOLTS
 COLOR TEMP. 4000K (MEDIUM WHITE)
 OPTICAL SYSTEM: TYPE III REFRACTIVE ACRYLIC OPTICS (ASYMMETRIC DISTRIBUTION)
 MODIFIER: 7 PIN TWIST-LOCK RECEPTACLE SUPPLIED WITH SHORTING CAP
 CATALOG NO.: ALMCHN-M1-LE100/EVX/L18-40-CR3-YSDP-TR7P-CU



Spring City Electrical Mfg. Co.

HALL AND MAIN STREETS - P.O. BOX 19 - SPRING CITY, PA. 19475
 PHONE (610) 948-4000 - FAX (610) 948-5577 - WWW.SPRINGCITY.COM

DESCRIPTION	THE CHINATOWN "M1" LED LUMINAIRE		
CUSTOMER			
JOB			
SCALE	DRAWN BY:	DATE	DRAWING NO.
N.T.S.	B.K.R.	05-03-2019	FIX-32448

This drawing is property of Spring City Elect. Mfg. and is issued to the recipient with the understanding that it shall not be copied, duplicated, passed on to unauthorized parties, nor used for any purpose other than that for which it is specifically furnished except with Spring City's written permission.

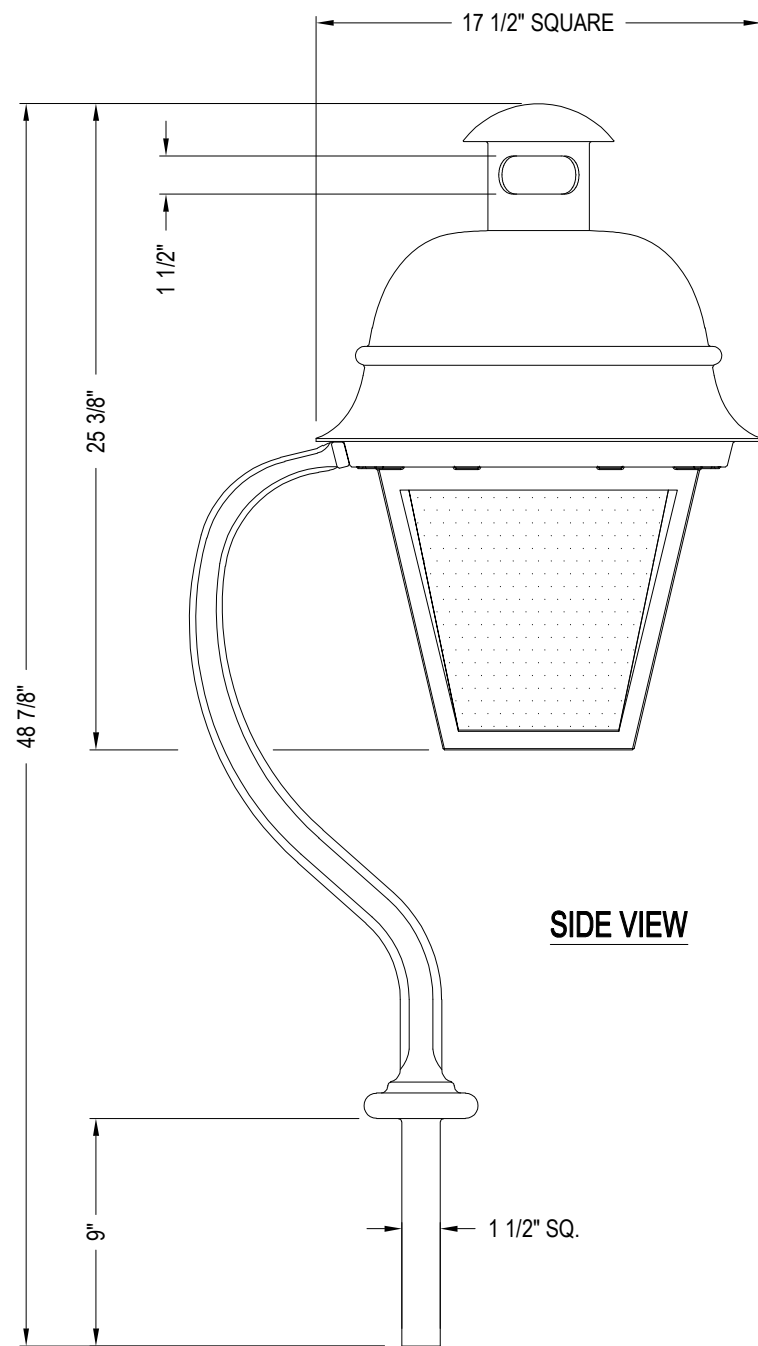

SIDE VIEW

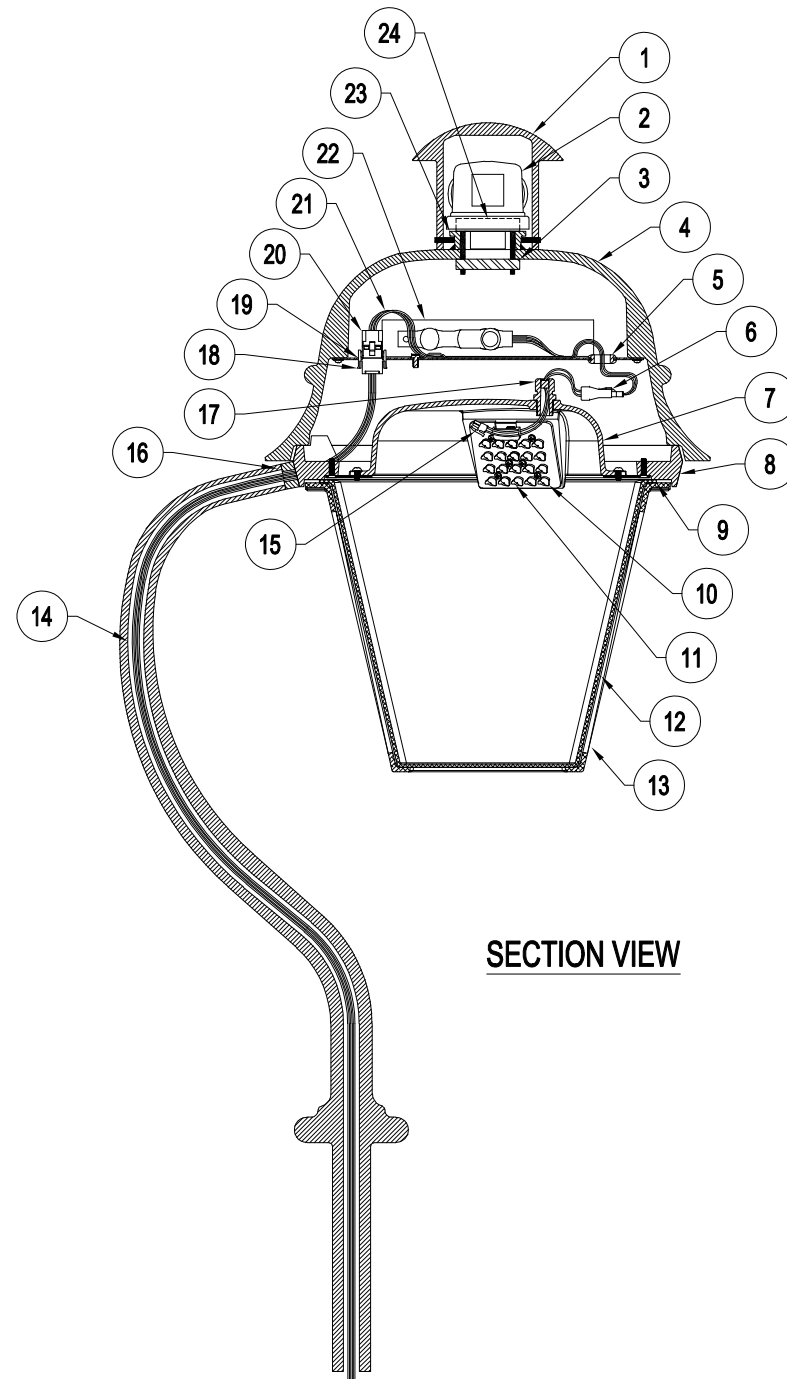

SECTION VIEW

- 1) DECORATIVE VENT HOOD: CAST ALUMINUM, 356 ALLOY, SECURED WITH (3) 10-24 X 3/4" SET SCREWS
- 2) PHOTO CELL: PLEASE ADVISE WHEN REQUIRED
- 3) PHOTO CELL RETAINER: FORMED GALVANIZED STEEL RETAINER TO SECURE PHOTO CELL RECEPTACLE
- 4) ROOF: CAST ALUMINUM, 356 ALLOY, WELDED TO MOUNTING RING
- 5) GROMMET: RUBBER GROMMET IN DRIVER MOUNTING PLATE
- 6) PUSH-IN QUICK DISCONNECT: 2 POLE BLACK/WHITE
- 7) COOLCAST HEAT DISSIPATING DOME: CAST ALUMINUM, 356 ALLOY, SECURED TO MOUNTING PLATE WITH (6) 1/4-20 X 3/8" LONG ROUND HEAD PHILLIPS HEAD MACHINE SCREWS, DOME TO BE ADJUSTABLE TO ALLOW FOR CUSTOM STREET SIDE ORIENTATION
- 8) CROOK RING: CAST ALUMINUM, 356 ALLOY, WELDED TO MOUNTING RING
- 9) GASKET: SILICONE GASKET
- 10) LED SYSTEM: 1 WATT LED CHIPS (CHIP COUNT DETERMINED BY REQUIRED WATTAGE)
- 11) CROSSFIRE OPTICAL SYSTEM: INJECTION MOLDED REFRACTIVE ACRYLIC, TYPE III (ASYMMETRIC) DISTRIBUTION (NOT SHOWN)
- 12) PANELS: SEEDED ACRYLIC PANELS WITH CLEAR ACRYLIC BOTTOM PANEL
- 13) LOWER OPEN CAGE: CAST ALUMINUM, 356 ALLOY, WELDED TO STRUTS
- 14) GOOSENECK CROOK: CAST ALUMINUM, 356 ALLOY, WELDED TO CROOK ADAPTOR, SUPPLIED WITH 10'-0" OF 10 GAUGE STRANDED COPPER LEAD WIRES (3) CONDUCTOR (THWN: BLACK, WHITE, & GREEN)
- 15) QUICK DISCONNECT: MICRO MATE-N-LOK CONNECTOR, 2 POSITION
- 16) CROOK ADAPTOR: CAST ALUMINUM, 356 ALLOY, WELDED TO GOOSENECK CROOK
- 17) CORD GRIP: MULTICORD LIQUID TIGHT NYLON CORD GRIP, 4 CORD, 3/8" NPT SIZE
- 18) QUICK DISCONNECT: MICRO MATE-N-LOK CONNECTOR, 3 POSITION, MALE
- 19) BRACKET: 16 GAUGE, GALVANIZED STEEL DRIVER BRACKET, SECURED WITH (4) 10-24 X 3/8" LONG ROUND HEAD PHILLIPS STAINLESS STEEL MACHINE SCREWS
- 20) QUICK DISCONNECT: UNIVERSAL MATE-N-LOK CONNECTOR, 3 POSITION, FEMALE, FIXED POSITION ON DRIVER BRACKET
- 21) LED DRIVER: DRIVER TO BE DETERMINED (BASED ON REQUIRED WATTAGE), SECURED WITH (2) 1/4"-20 X 3/8" LONG ROUND HEAD PHILLIPS STAINLESS STEEL MACHINE SCREWS
- 22) SURGE PROTECTOR: 10kV PROTECTION
- 23) PHOTO CELL MOUNTING PROVISION: CAST ALUMINUM, 356 ALLOY, WELDED CLOSED TOP ROOF
- 24) RECEPTACLE: TWIST LOCK PHOTO CELL RECEPTACLE, SECURED TO CLOSED ROOF WITH (2) 6-32 X 2" LONG ROUND HEAD PHILLIPS STAINLESS STEEL MACHINE SCREWS

LUMINAIRE SPECIFICATIONS

STYLE: FRANKLIN GOOSENECK (M4) LED LUMINAIRE
 HEIGHT: 25 3/8"
 WIDTH: 17 1/2" SQUARE
 MATERIAL: CAST ALUMINUM ALLOY A.N.S.I. 356, PER A.S.T.M. B26-95
 PANELS: SEEDED ACRYLIC PANELS WITH CLEAR ACRYLIC BOTTOM PANEL
 FINISH: POWDER COAT - RIVER TEXTURE GLOSS BLACK
 LAMPING: 40 WATT LED SYSTEM
 COLOR TEMP: SEE BELOW
 VOLTAGE: ELECTRONIC 120-277 VOLTS
 OPTICS: TYPE III REFRACTIVE ACRYLIC OPTICS (ASYMMETRIC DISTRIBUTION)
 PHOTO CONTROL: 7-PIN TWIST LOCK DIMMING RECEPTACLE (PHOTOCELL BY OTHERS)
 CATALOG NO.: ALMFRK-M4-LE040/EVX/X2-_-CR3-YSDP-TR7P-FRG-CU

COLOR TEMPERATURE	CAT. NO.
2200K (GOLDEN WHITE)	22
3000K (WARM WHITE)	30
4000K (MEDIUM WHITE)	40



Spring City Electrical Mfg. Co.

HALL AND MAIN STREETS - P.O. BOX 19 - SPRING CITY, PA. 19475
 PHONE (610) 948-4000 - FAX (610) 948-5577 - WWW.SPRINGCITY.COM

DESCRIPTION	THE FRANKLIN GOOSENECK (M4) LED LUMINAIRE		
CUSTOMER	JOB		
SCALE	DRAWN BY:	DATE	DRAWING NO.
N.T.S.	B.K.R.	01-17-2017	FIX-29811